

# PIANO OCCUPAZIONE DELLE AULE ANNO SCOLASTICO 2020/2021

Rev. 07/10/2020

CLASSE	AULA	ALUNNI	CLASSE	AULA	ALUNNI	CLASSE	AULA	ALUNNI	CLASSE	AULA	ALUNNI	CLASSE	AULA	ALUNNI
1A	703	18	2A	706	16	3A	316	19	4A	312	17	5A	307	15
1B	704	16	2B	724	16	3B	314	22	4B	709	16			
			2C	705	15									
1D	803	22	2D	819	18				4D	306	20	5D/ E art.	414	15
1E	820	19	2E	811	18	3E	902/903	21					200	5
1F	717	20	2F	720	15	3F	415	19	4F	714	18	5F	204	22
1G	617	18	2G	716	15									
1H	718	22	2H	711	16	3H	303/304	27	4H	111	15	5H	410	19
			2I	912/913	21	3I	209/210	22	4I	615	15	5I	203	21
			2L	315	17									
1M	603	15	2M	710	15	3M	211	17	4M	814	19	5M	201	12
1N	726	15	2N	810	17	3N	405	16				5N	804	15
			2U	719	16									
			2X	205	15				4X	310	13	5X	408	16
1Y	713	14	2Y	313	13	3Y	202	20	4Y	206	18	5Y	207	20
1V	915	24	2V	712	20									
1Z	807	25	2Z	722	22	3Z	904/905/906	22						
1K	818	20												
1O	805	13	2O	812	21	3O	911	22	4O	817	22	5O	208	18
1P	723	13	2P	725	18							5P	311	16
n. Studenti cl. 1°		274	n. Studenti cl. 2°		324	n. Studenti cl. 3°		227	n. Studenti cl. 4°		173	n. Studenti cl. 5°		194
Classi prime 15			Classi seconde 19			Classi terze 11			Classi quarte 10			Classi quinte 11		

\* IN ROSSO LE VARIAZIONI

n. classi 66

Totale studenti 1192 al 07/10/2020

QUADRO RIEPILOGATIVO DATI

**Totale classi 66, totale alunni 1192, ed. Centrale n. 490 alunni, ed. Succursale n. 689 alunni *Rev. del 07/10/2020***

**Succursale:**

<b>3 classi al piano terra</b>	<b>48 alunni</b>	
<b>20 classi al piano primo</b>	<b>336 alunni</b>	
<b>12 classi al piano secondo</b>	<b>229 alunni</b>	
<b>5 classi al piano terzo</b>	<b>110 alunni</b>	
<hr/>		
<b>40 classi in succursale</b>	<b>723 alunni in succursale</b>	<b>(60,6%)</b>

**Sede:**

<b>1 classe al piano primo</b>	<b>15 alunni</b>	
<b>10 classi al piano secondo</b>	<b>175 alunni</b>	
<b>10 classi al piano terzo</b>	<b>179 alunni</b>	
<b>5 classi al piano quarto</b>	<b>90 alunni</b>	
<hr/>		
<b>26 classi in centrale</b>	<b>464 alunni</b>	<b>(38,9%)</b>

**Totale n. 66 classi                      1192 totale alunni**

Palermo, li *07/10/2020*



# PIANO OCCUPAZIONE AULE 2020/2021

I.I.S.S. "A. VOLTA" SUCCURSALE PIANO TERRA

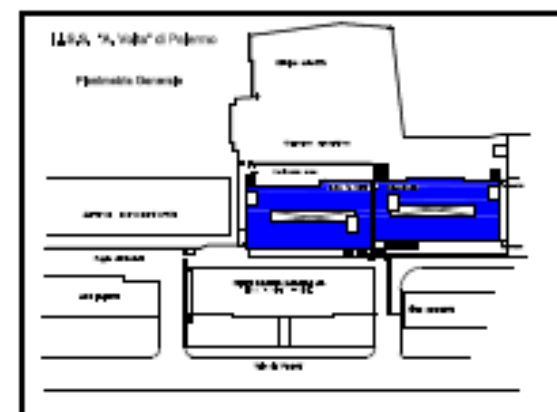
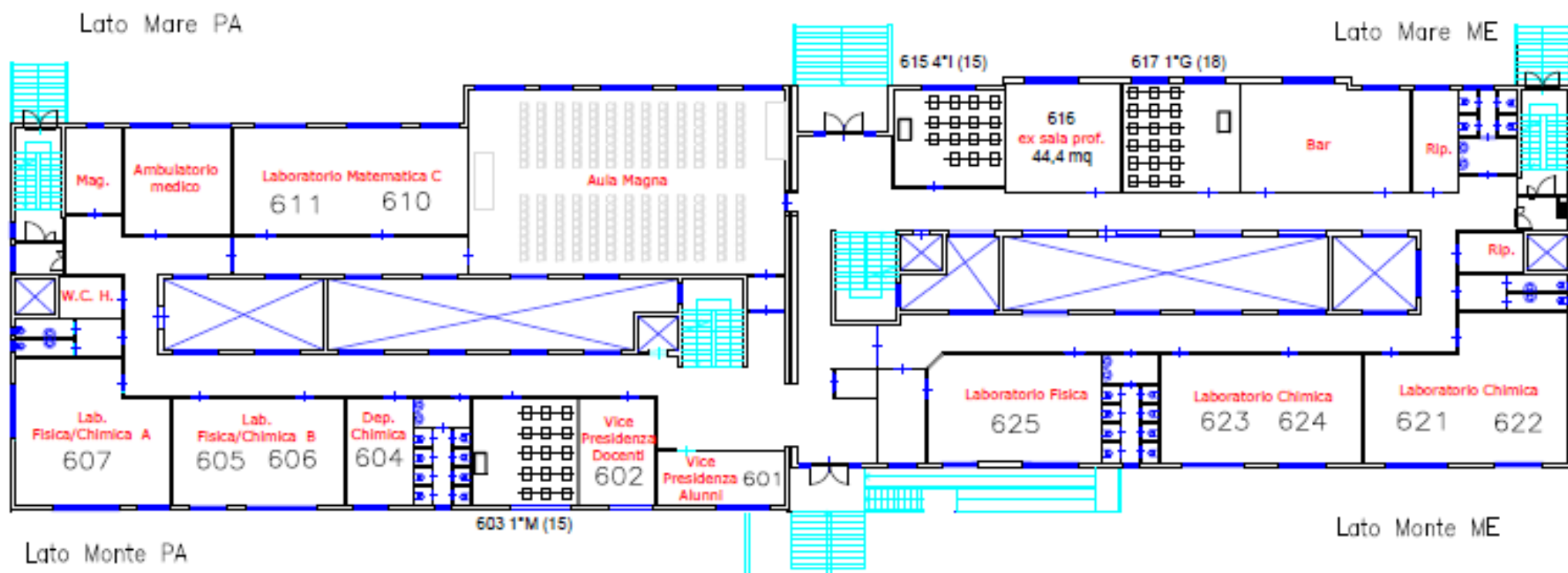



# PIANO OCCUPAZIONE AULE 2020/2021

I.I.S.S. "A. VOLTA" SUCCURSALE PIANO PRIMO

Lato Mare PA

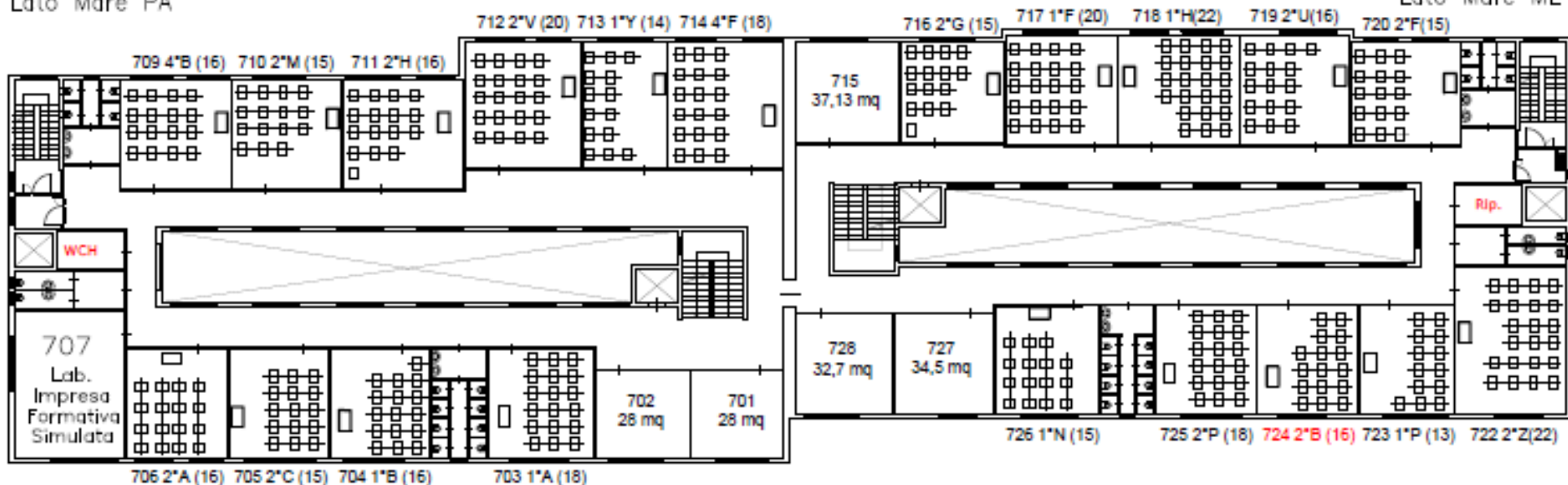

Lato Monte PA

Lato Monte ME

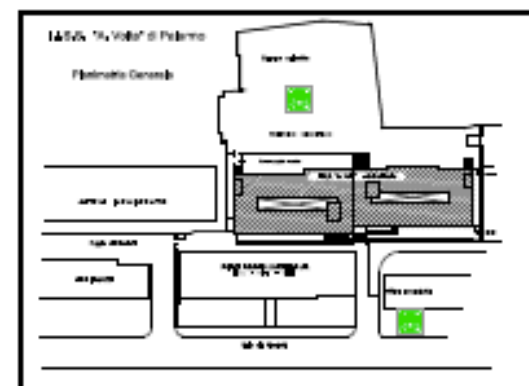



# PIANO OCCUPAZIONE AULE 2020/2021

I.I.S.S. "A. VOLTA" SUCCURSALE PIANO SECONDO

Lato Mare PA

Lato Mare ME



Lato Monte PA

Lato Monte ME

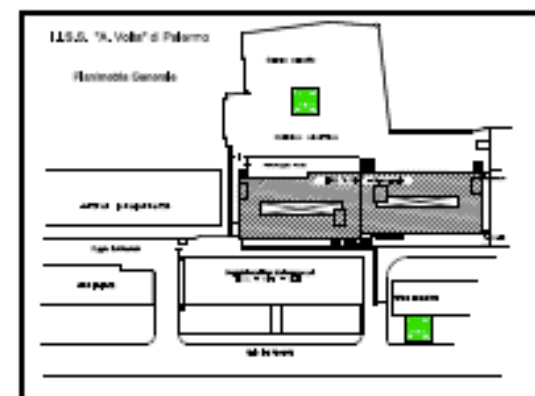



# PIANO OCCUPAZIONE AULE 2020/2021

I.I.S.S. "A. VOLTA" SUCCURSALE PIANO TERZO

Lato Mare PA

912/913 2\*1 (21)  
Laboratorio Fisica B

915 1\*V (24)  
Laboratorio Fisica C

Lato Mare ME

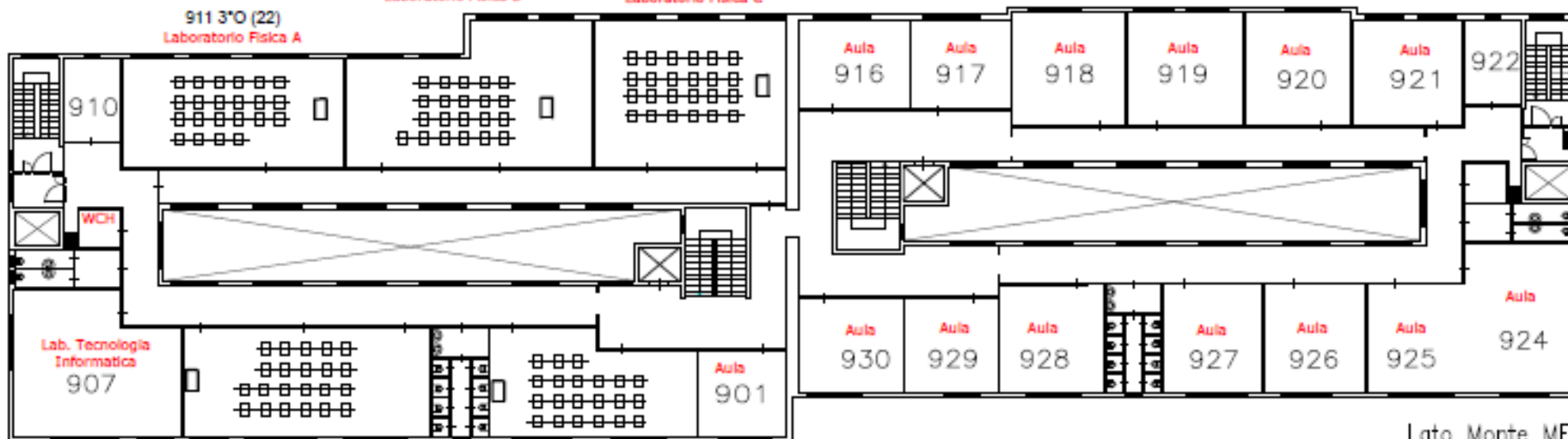

Lato Monte PA

904/905/906 3\*Z (22)  
Lab. Tecnologia Meccanica B

902 903 3\*E (21)  
Aula Disegno

Lato Monte ME

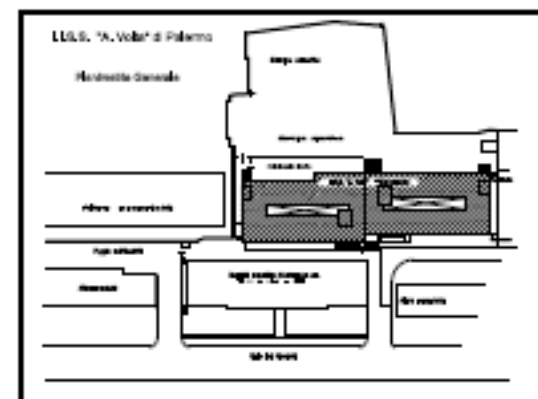



# PIANO OCCUPAZIONE AULE 2020/2021

I.I.S.S. "A. VOLTA" SEDE PIANO PRIMO

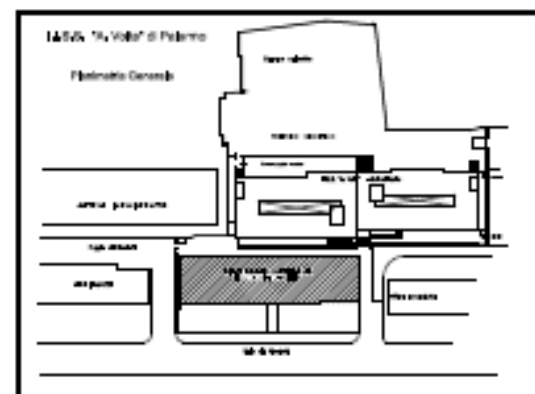
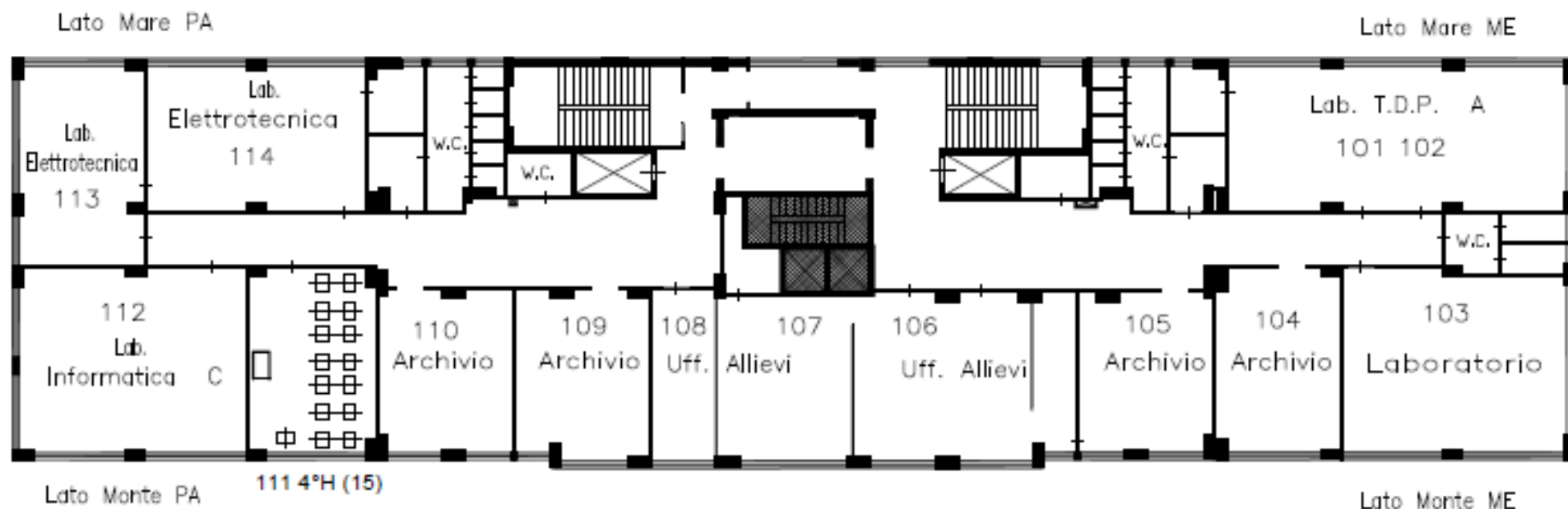



# PIANO OCCUPAZIONE AULE 2020/2021

I.I.S.S. "A. VOLTA" SEDE PIANO SECONDO

Lato Mare PA

Lato Mare ME

200 5°E (5) 201 5°M (12) 202 3°Y (20)

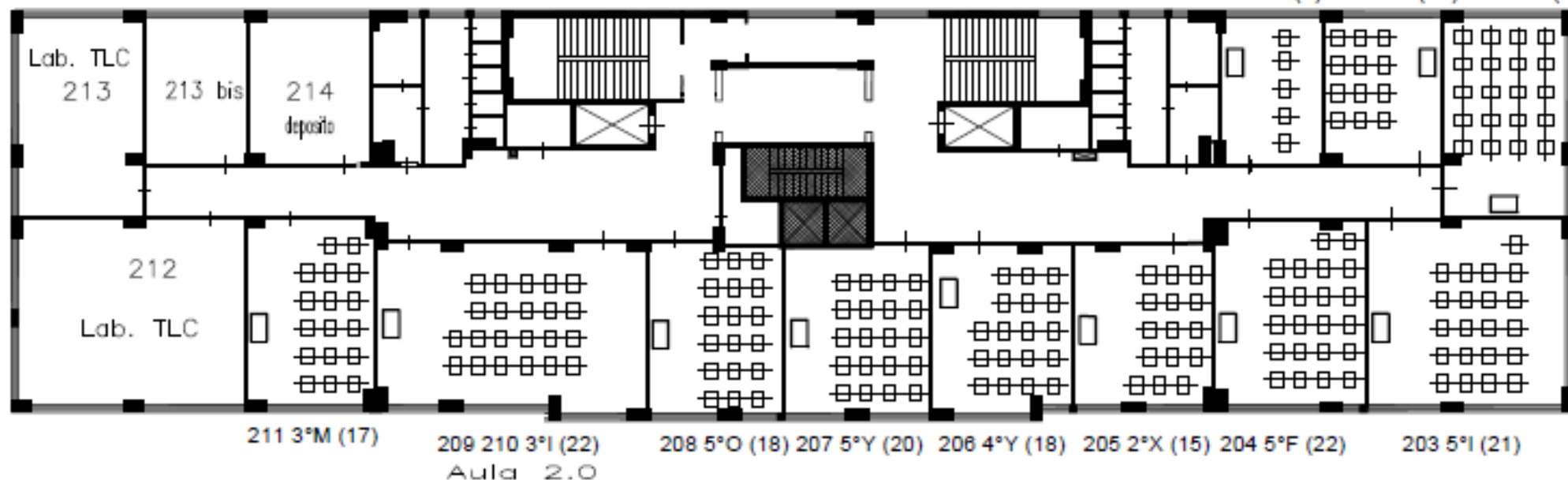

Lato Monte PA

Lato Monte ME

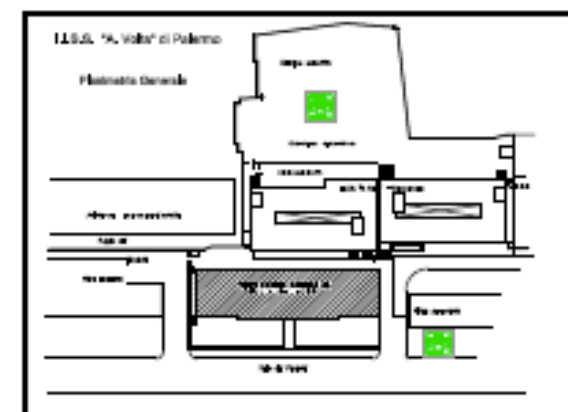





# PIANO OCCUPAZIONE AULE 2020/2021

I.I.S.S. "A. VOLTA" SEDE PIANO TERZO

Lato Mare PA

Lato Mare ME

315 2°L (17) 316 3°A (19)

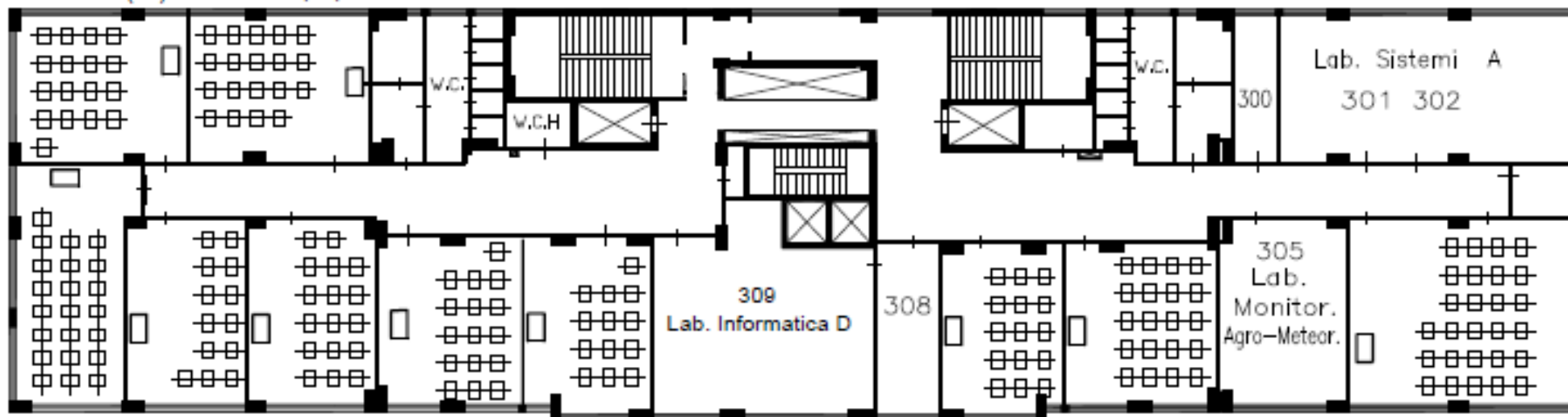

314 3°B (22) 313 2°Y (13) 312 4°A (17) 311 5°P (16) 310 4°X (13)

307 5°A (15) 306 4°D (20)

303 304 3°H (27)  
Laboratorio

Lato Monte PA

Lato Monte ME

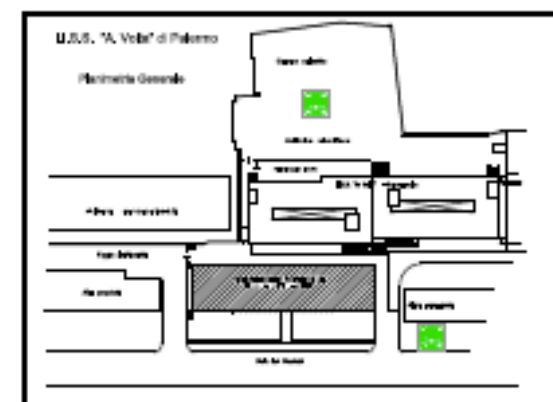



# PIANO OCCUPAZIONE AULE 2020/2021

I.I.S.S. "A. VOLTA" SEDE PIANO QUARTO

